

Item 13A.2

Notes:
 Do not scale off the drawings.
 Check all dimensions on site.
 All work must comply with the relevant BCA clauses & Australian Standards.
 These drawings must be read in conjunction with engineer's drawings & relevant council requirements.
 All building work to be carried using best practice.
 Existing work to be retained is to be protected during demolition & new building work.



Notes:
 Stormwater drainage to comply with BCA Clause F1.1
 Roof coverings to comply with BCA Clause F1.5
 Waterproofing to facilities to comply with BCA Clause F1.7
 Artificial lighting to toilet facilities to comply with BCA Clause F4.4
 Ventilation to toilet facilities to comply with BCA Clauses F4.5 & F4.9b
 Emergency exit to have latch complying with BCA Clause D2.21
 Provide fire extinguishers for risk class c required by BCA Clause E1.6 & Table E1.6.
 Water temperature to all disabled sanitary fixtures not to exceed 43.5°C and 50°C to all other fixtures.
 Termite protection to AS 3660.1.
 Install RPZ backflow device to comply with AS 3500 Part 1.
 All materials used in construction of the building to BCA Spec. C1.10.
 Exit doors & path of travel doors to comply with BCA Clauses D2.19, D2.20 & D2.21.
 All glazing to windows & doors to comply with AS 1288 1994.

AGS COMMERCIAL Pty Ltd
 172 Casino Street, South Lismore
 PO Box 680 Lismore NSW 2480
 phone 02 66223745
 fax 02 66219455
 www.allsteelgarages.com.au
 RICHMOND VALLEY BUILDING DESIGN

No	Description	Date
	Project Status	20/02/16

No	Description	Date

Proposed Alterations & Additions to Kyogle SES Building
 Kyogle Council
 Ettrick Street Kyogle

Site Plan

Project number	AGSses	A01	1/4
Date	Feb16		
Drawn by	CW		
Checked by	SB	Scale	1 : 200 © Copyright

ETTRICK STREET

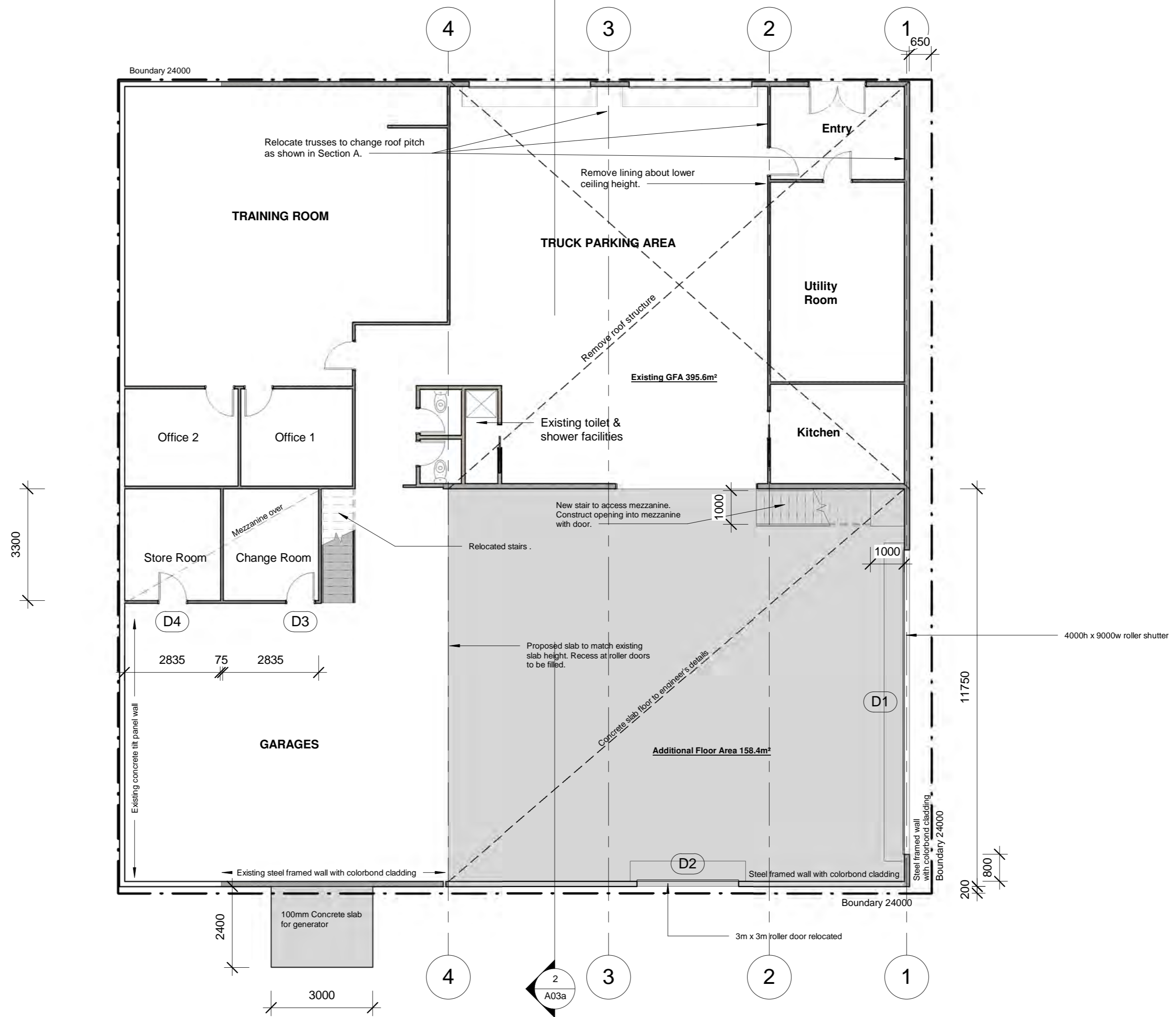

AGS COMMERCIAL Pty Ltd
 172 Casino Street, South Lismore
 PO Box 680 Lismore NSW 2480
 phone 02 66223745
 fax 02 66219455
 www.allsteelgarages.com.au
 RICHMOND VALLEY BUILDING DESIGN

No	Description	Date
	Project Status	20/02/16
a	added slab	01/03/16

No	Description	Date

Proposed Alterations & Additions to Kyogle
 SES Building
 Kyogle Council
 Ettrick Street Kyogle

Proposed Floor Plan

Project number	AGSses	A02a	2/5
Date	Feb16		
Drawn by	CW	Scale	1:100
Checked by	SB	© Copyright	